



Flexible cables

- High resistance and low actioning efforts
- Weatherproof resistance

Working conditions

Max. load: in traction	1450 N - 340 lbf
in compression	880 N - 198 lbf
Minimum recommended bend radius	R = 150 mm - 5.9 in
Working temperature	from -20 to 80 °C - from -4°F to 176°F
Maximum recommended length	5000 mm - 157.48 in

Dimensions

CD cable

Flexible polyurethane cable with 5 wires: 0.75 mm² - 0.0012 in² (Ø external 5.2 mm - 0.20 in, Ø wire 1.55 mm - 0.06 in) with one fixing end and one turning end.

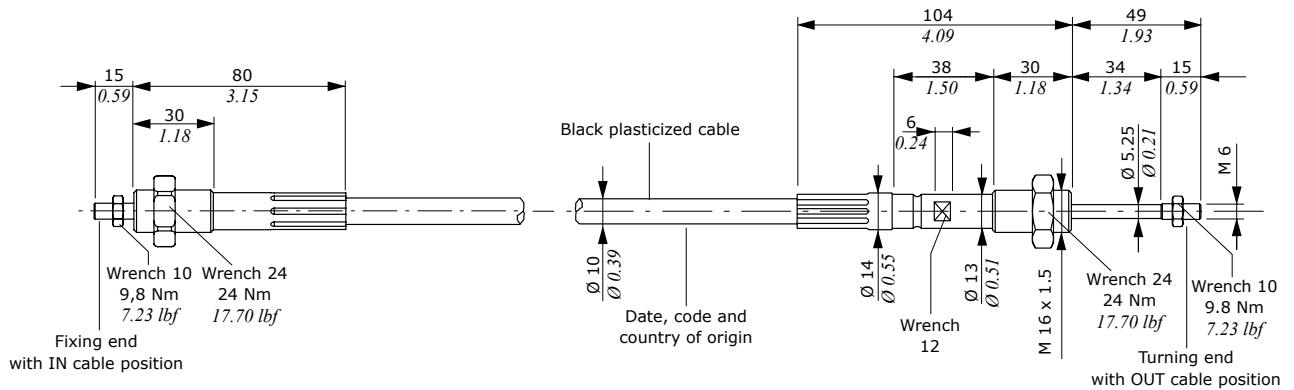

CG cable

Flexible polyurethane cable with 5 wires: 0.75 mm² - 0.0012 in² (Ø external 5.2 mm - 0.20 in, Ø wire 1.55 mm - 0.06 in) with both turning ends.

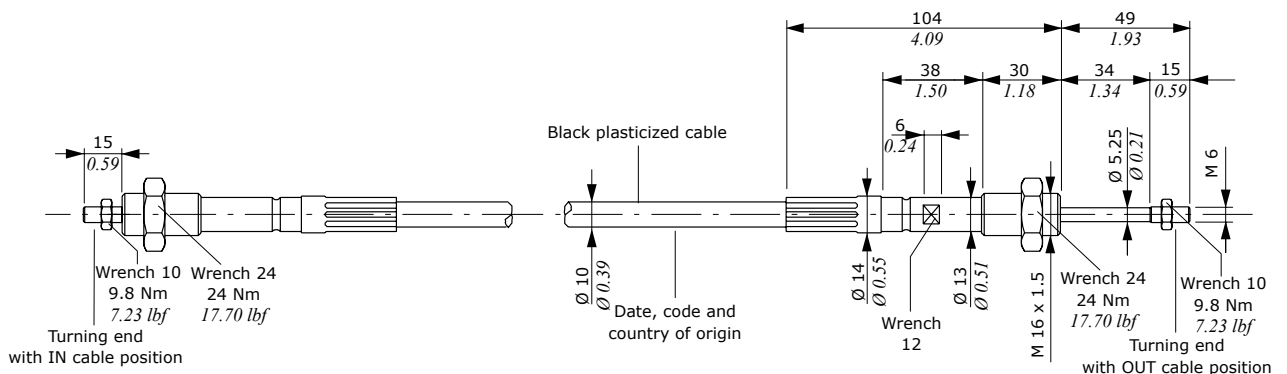

Ordering codes for flexible cables

Connecting scheme

Flexible cables and connecting kit at both ends are used to join TCC or SCF control group to the directional valve.

On the TCC series remote control there is always a GP kit; on the valve, the kit choice depends on the cable. The TP kit is used with CG cable with turning ends. The CP kit must be used instead of TP one when TL control is mounted on the valve, with the lever on the opposite side.

On the SCF031/32 remote control the TQ kit is assembled on the spool end side and it allows the connection of the cable to the directional valve. It's waterproof and it permits freedom of movement to fixed end cables.

TCC5/1/ML + GP50 + CG1000 + TP50



TCC5/1/ML + GP50 + CD1000 + TQ50

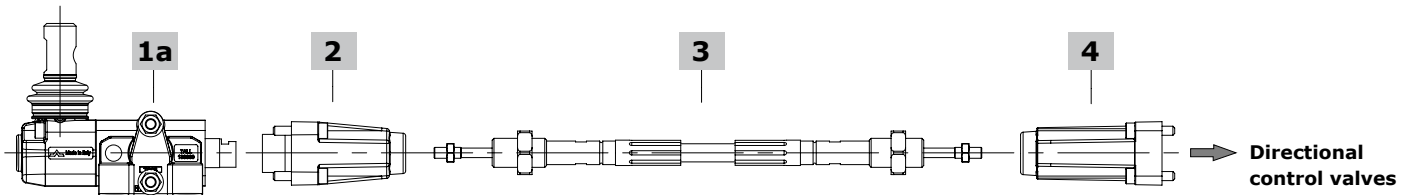

SCF031/02FW + CD1500 x2 + TQ70

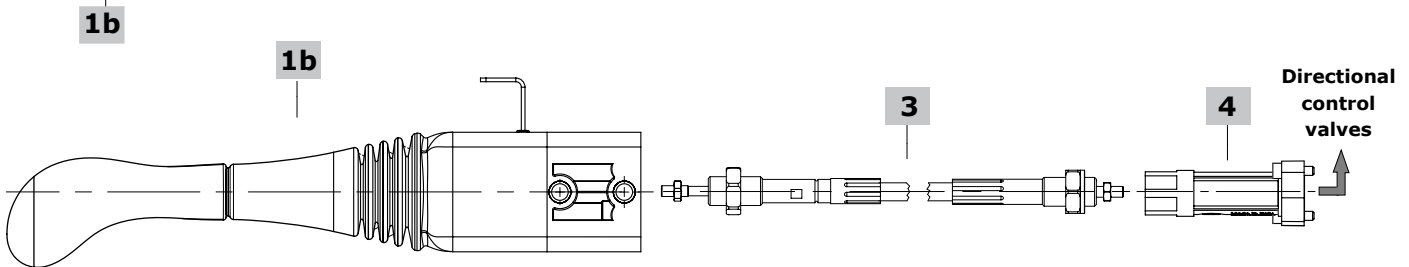

Ordering codes for flexible cables and connection kit

1a TCC remote control page 5-9

1b SCF031 remote control page 11-16

2 Control connection kit

TYPE	CODE	DESCRIPTION
GP50	5TEL005005	Kit for TCC5
GP100	5TEL010005	Kit for TCC10

3 Flexible cables

TYPE	CODE	DESCRIPTION
CD type: with one fixing end and one turning end		
CD1000	4CAV601000	Length 1000 mm - 39.37 in
CD1250	4CAV601250	Length 1250 mm - 49.21 in
CD1500	4CAV601500	Length 1500 mm - 59.05 in
CD1750	4CAV601750	Length 1750 mm - 68.90 in
CD2000	4CAV602000	Length 2000 mm - 78.74 in
CD2500	4CAV602500	Length 2500 mm - 98.42 in
CD3000	4CAV603000	Length 3000 mm - 118.11 in
CD3500	4CAV603500	Length 3500 mm - 137.79 in

3 Flexible cables (continue)

CG type: with both turning ends

CG1000	4CAV701000	Length 1000 mm - 39.37 in
CG1250	4CAV701250	Length 1250 mm - 49.21 in
CG1500	4CAV701500	Length 1500 mm - 59.05 in
CG1750	4CAV701750	Length 1750 mm - 68.90 in
CG2000	4CAV702000	Length 2000 mm - 78.74 in
CG2250	4CAV702250	Length 2250 mm - 88.58 in
CG2500	4CAV702500	Length 2500 mm - 98.42 in
CG3000	4CAV703000	Length 3000 mm - 118.11 in
CG3500	4CAV703500	Length 3500 mm - 137.79 in
CG4000	4CAV704000	Length 4000 mm - 157.48 in
CG4500	4CAV704500	Length 4500 mm - 177.16 in
CG5000	4CAV705000	Length 5000 mm - 196.85 in

4 Valve connection kit

See page 19

