

FEATURES

- ✓ **Rugged Design:** Heavy duty subplates handle pressure shocks and severe applications.
- ✓ **Easy Valve Replacement:** Subplate mounted valves allow for quick valve replacement without disrupting plumbing.
- ✓ **New High Flow D05:** SD05H-16FS-S Subplates with two tank line connections to the D05 pattern.

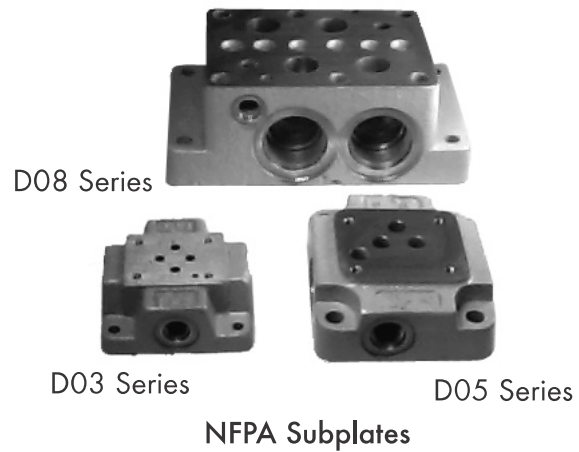

Specifications

Size	D03	D05		D08	
Mounting Surfaces: General Patterns		D05- Standard 	D05H- High Flow 		
Model Number					
Side Ports	SAE Ports	SD03-6FS-S	SD05-8FS-S	SD05H-16FS-S	SD08-16FS-S
	NPT Ports	SD03-6FP-S	SD05-8FP-S	N/A	SD08-16FP-S
Bottom Ports	SAE Ports	SD03-6FS-B	SD05-8FS-B	N/A	N/A
	NPT Ports	SD03-6FP-B	SD05-8FP-B	N/A	N/A
Mounting Surface	NFPA	T3.5.1.MR1-F1984-03	T3.5.1.MR1-F1984-D05	T3.5.1.MR1-D05	T3.5.1.MR1-D08
	ISO	ISO 4401-03	ISO 4401-05	ISO 4401-05	ISO 4401-08
Nominal Flow Rates	5 gpm (19 lpm)	12 gpm (45 lpm)	25 gpm (95 lpm)	50 gpm (190 lpm)	
Material	Ductile Cast Iron	Ductile Cast Iron	Nickel Plated Steel	Ductile Cast Iron	
Maximum Pressure	Cast Iron 5000 psi (350 bar) Aluminum (optional) 3000 psi (210 bar)				
Recommended Fluids	Petroleum Based Fluids- ISO VG32-68, Phosphate Ester, Most Vegetable Oils, Water Based Fluids to 40% Water				

Dimensional Data

Series SD03

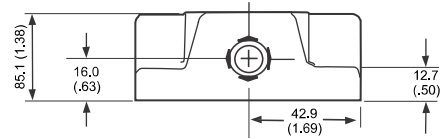
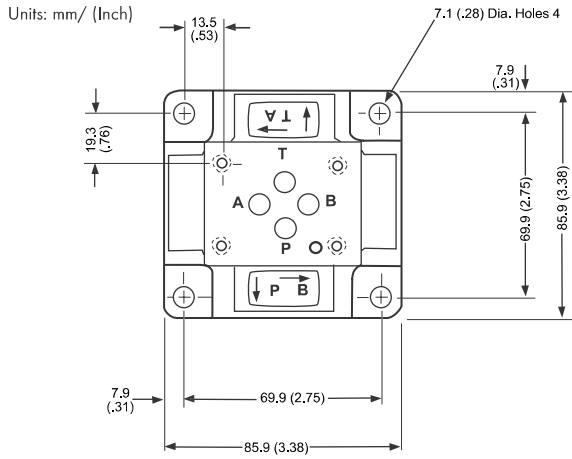

SD03-6F*-S
Side Ported

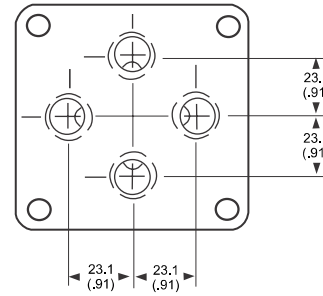

SD03-6FP-B
Bottom Ported

Series SD05

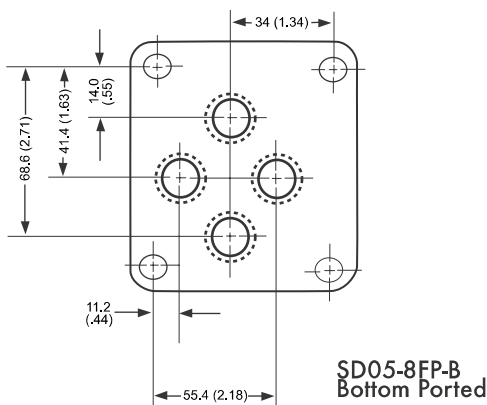
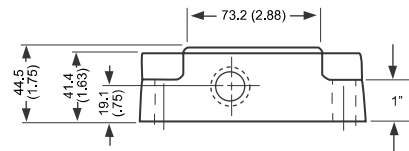
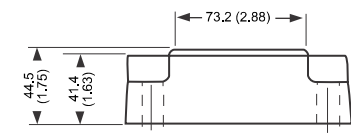
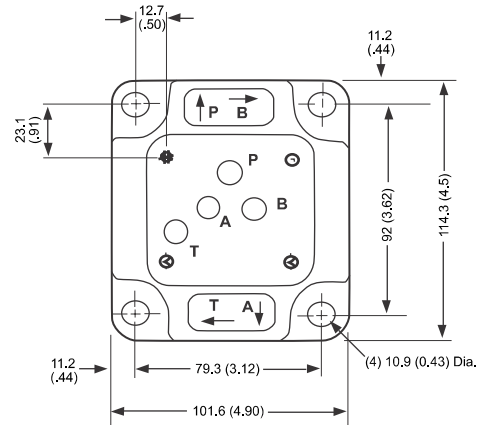
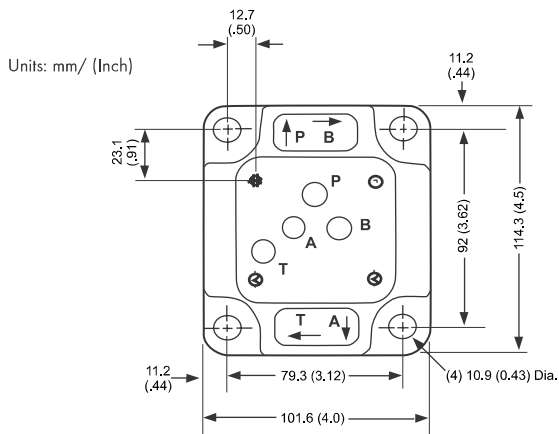

SD05-8FP-B
Bottom Ported

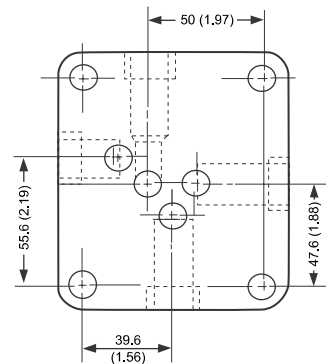

SD05-8F*-S
Side Ported

Dimensional Data

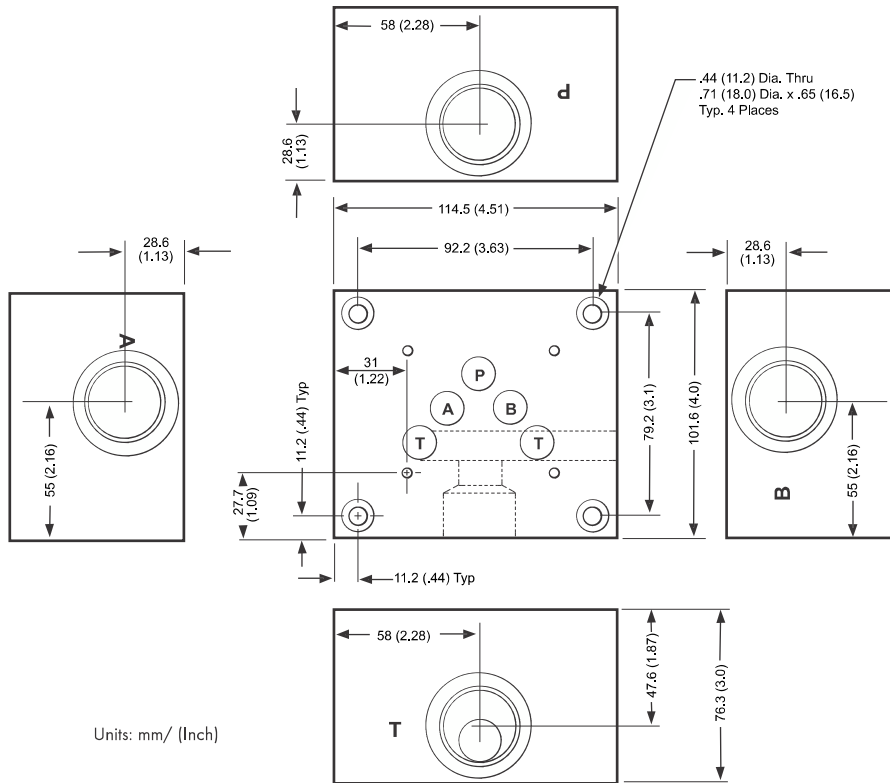

Series SD05H



SD05H-16FS-S-A
Hi-Flow Subplate

ORDERING INFORMATION



SUBPLATE PART NUMBERING SYSTEM:

S D05 - 8 - FS - S

Subplate

Code	Size
6	3/8"
8	1/2"
16	1"

Code	Connection
S	Side Ports
B	Bottom Ports

Size
D03
D05
D05H
D08

Code	Connection
FP	Female Pipe
FS	Female SAE

Material:
Ductile Cast Iron
(SD05H is Nickel Plated Steel)

Series SD08

