

Check Valve CNT Series

Features and Handling

• CNT Series are check valve with optional cracking pressure. The valves allow free flow in one direction and shut-off in the other direction. The valve comes with flow rate ranges from 30L/min to 500 L/min and port size from 3/8" to 2".

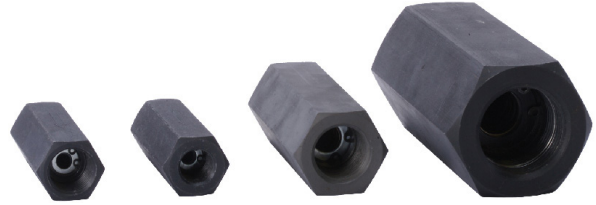

Specification

Model	Maximum Flow L/min (USgpm)	Maximum Pressure bar (psi)	Weight kg (lb)
CNT-T03	30 (7.9)	315 (4600)	0.15 (0.33)
CNT-T04	50 (13.2)		0.29 (0.63)
CNT-T06	140 (36.9)		0.48 (1.05)
CNT-T08	220 (58.1)		0.90 (1.98)
CNT-T10	320 (84.5)		2.00 (4.40)
CNT-T12	430 (113.59)		2.50 (5.50)
CNT-T16	500 (132.08)		3.00 (6.61)

Ordering Code

CNT - T03 - A

1 2 3 4

1. Model : CNT

2. Mounting

T - Threaded connections

3. Valve size

03 - 3/8"
04 - 1/2"
06 - 3/4"
08 - 1"
10 - 1-1/4"
12 - 1-1/2"
16 - 2"

4. Cracking Pressure

A - 0.5 bar (7 psi)
B - 4.0 bar (58 psi)

Check Valve CNT Series

Installation Dimensions mm (inch)

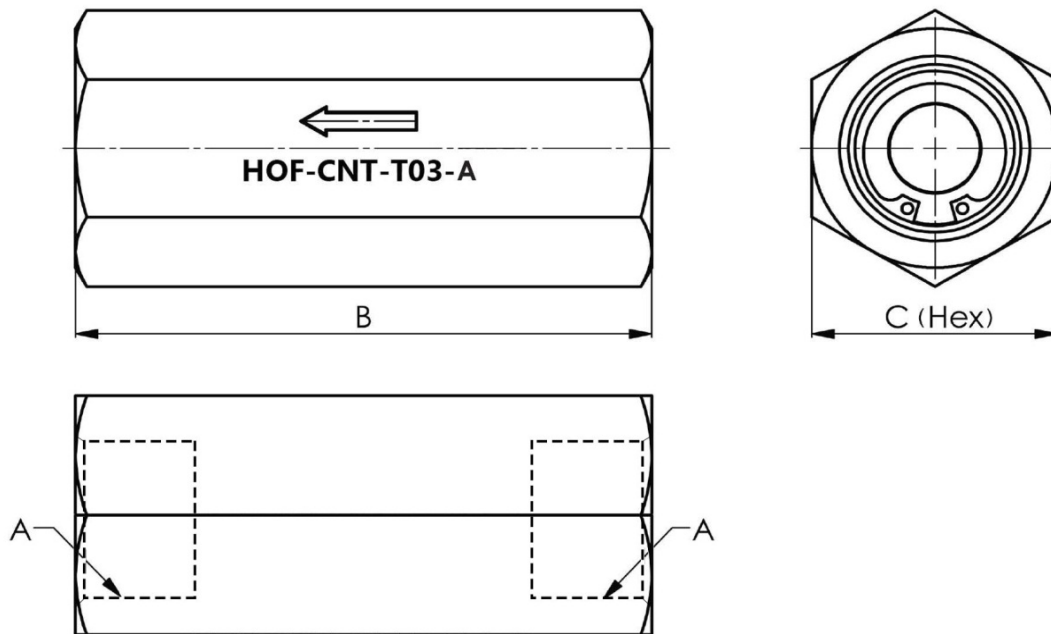

Model	Dimension mm (inch)		
	A Thread	B	C
CNT-T03	3/8"BSP	58.0 (2.28)	24.0 (0.94)
CNT-T04	1/2"BSP	72.0 (2.83)	30.0 (1.18)
CNT-T06	3/4"BSP	85.0 (3.34)	36.0 (1.41)
CNT-T08	1"BSP	98.0 (3.85)	46.0 (1.81)
CNT-T10	1-1/4"BSP	120.0 (4.72)	60.0 (2.36)
CNT-T12	1-1/2"BSP	138.0 (5.43)	65.0 (2.55)
CNT-T16	2" BSP	155.0 (6.10)	75.0 (2.95)

Check Valve CNT Series

Performance Characteristics

Pressure Drop

Characteristics measured at $\nu = 32 \text{ cSt (156 SUS)}$

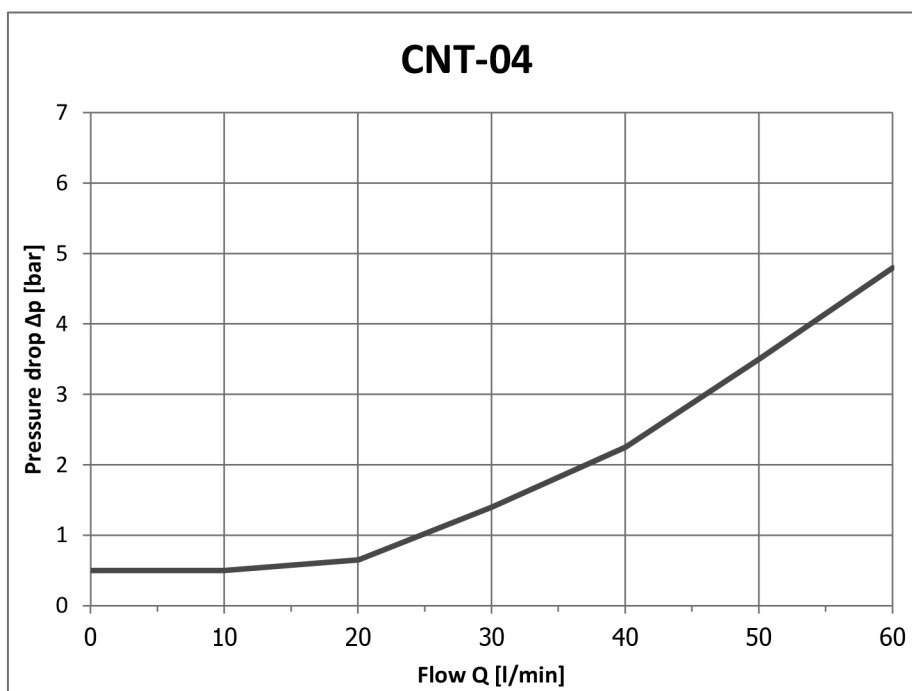
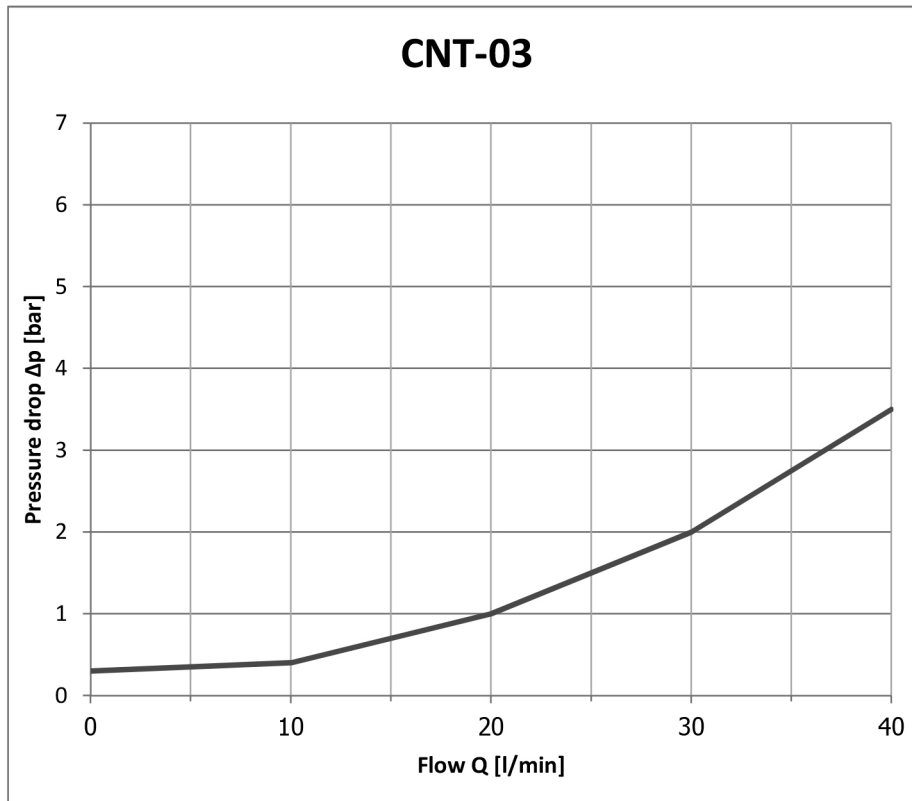

Check Valve CNT Series

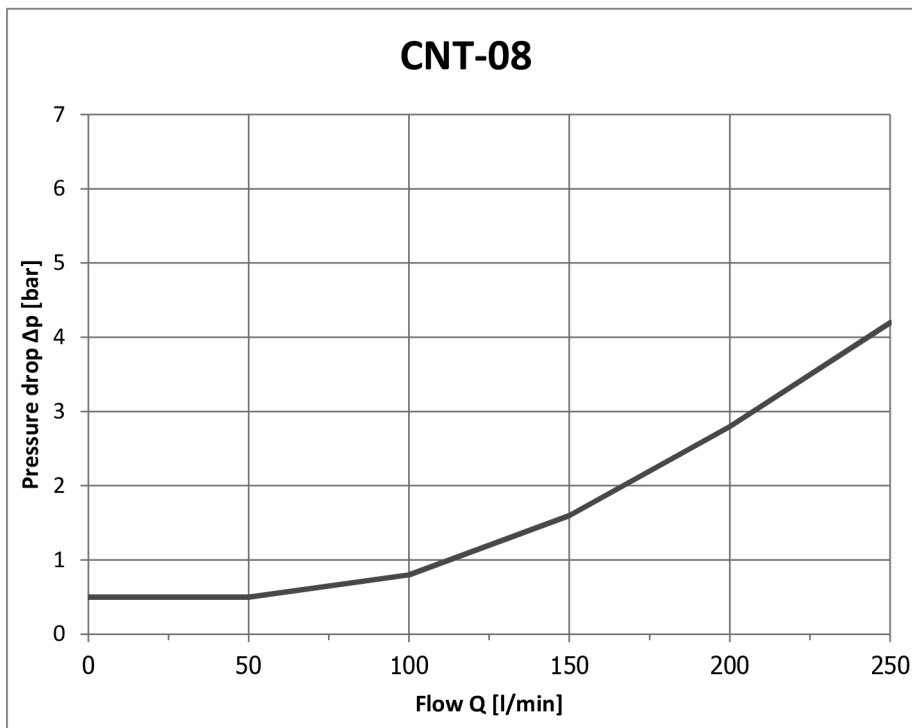
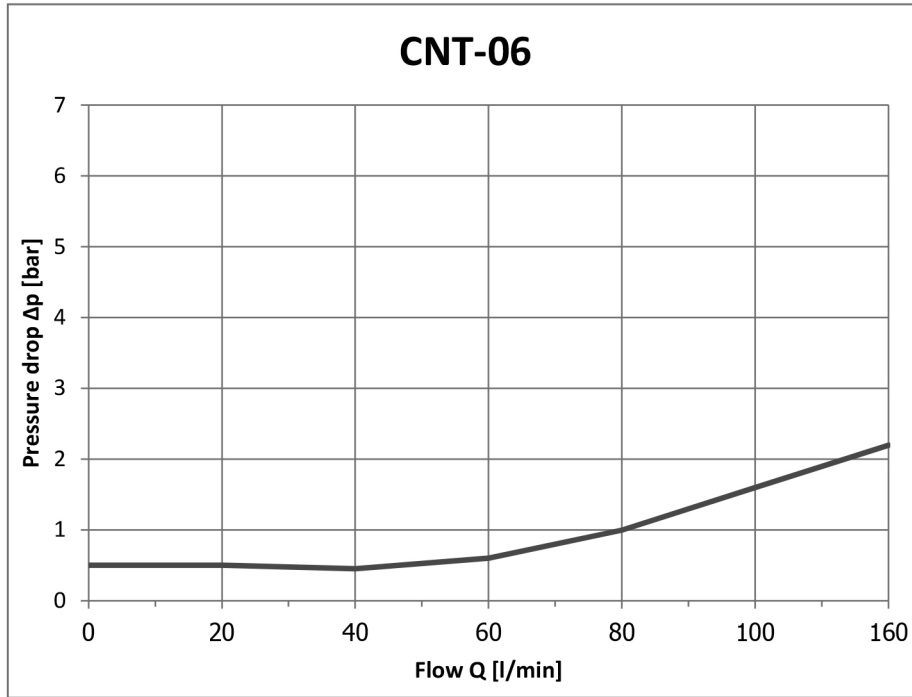

Check Valve CNT Series

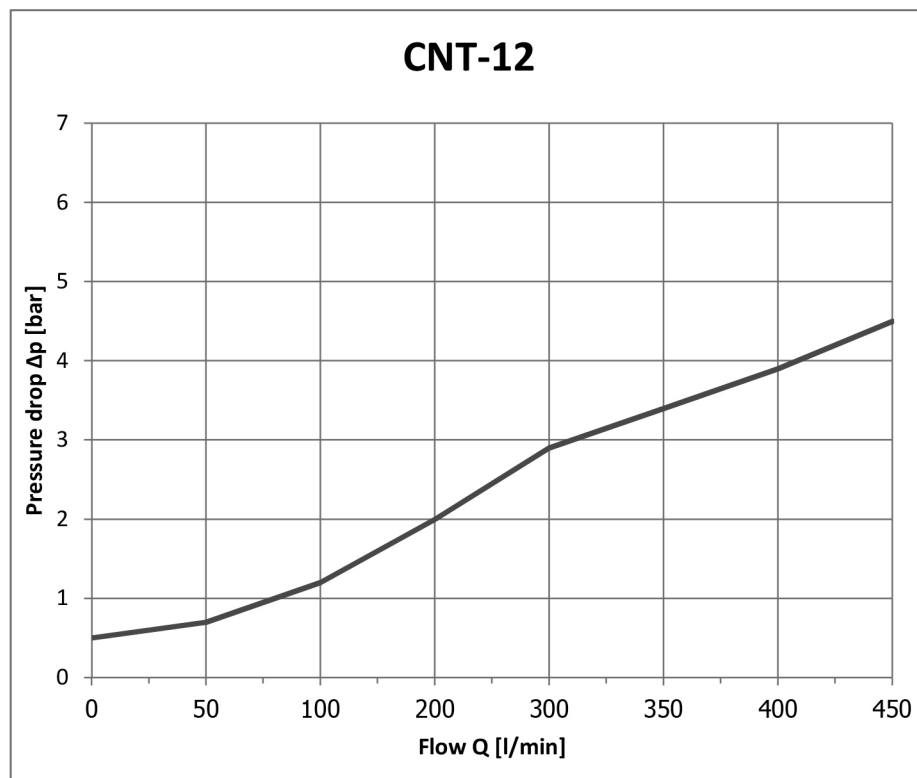
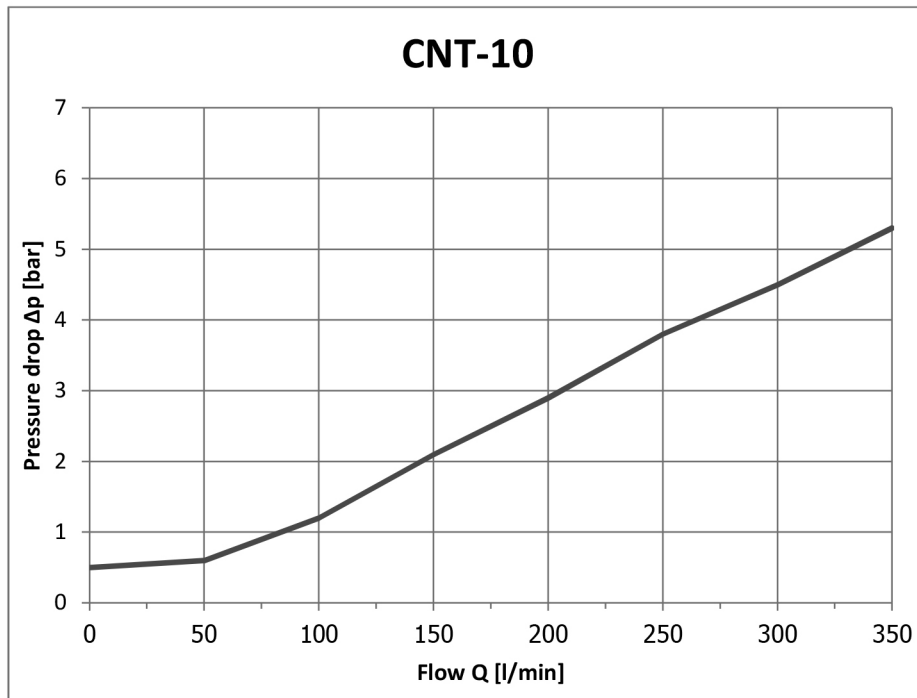

Check Valve CNT Series

